

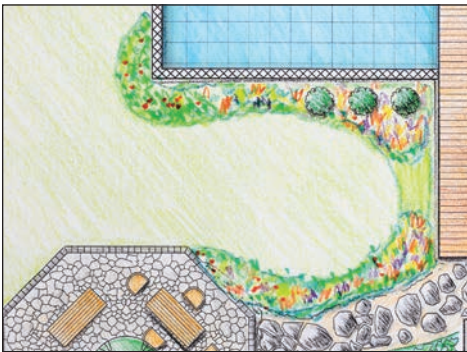

13 STEP Installation Process

Installing Golden Value Synthetic Turf involves preparing the base, much like you would to install pavers, and laying the turf, similar to how you would install carpet. Synthetic turf works best on a flat, compacted, well-draining substrate. Installation steps are highlighted below. For more detailed information, visit our website.

1 | Gather Tools



2 | Lay Out the Site



3 | Excavate & Grade



4 | Install Bender Board Edging



5 | Prepare Base



6 | Roll Out, Position Turf and Trim Selvage Edge



7 | Stretch Turf



8 | Seam Each Piece of Turf



9 | Trim & Cut



10 | Nail & Fasten



11 | Add Fill



12 | Brush To Lift Blades



13 | Clean Up

PRO TIPS

Check out the **Outdoor Living Supply Academy** YouTube page to view the full installation video: ***How to Install Golden Vale Synthetic Turf.***

PRO TIP 1 | (Step 4) Consistent compaction is critical to the success of your project. Always compact in 1 to 2 inch lifts. Take your time and do it right!

PRO TIP 2 | (Step 8) When seaming, ensure the blade direction from each piece is installed in the same direction.

PRO TIP 3 | (Step 8) Make a mark where the two pieces of turf meet so that you can line up the center line on the seam tape to the center of the seam. This will ensure complete and even adhesive coverage on both sides of the seam.

PRO TIP 4 | (Step 8) Be extremely careful when working with turf adhesive as it will stick to anything and everything! Using too much glue could impact the lay of the turf, resulting in visible seams.

PRO TIP 5 | (Step 8) Always install the seams with a two or three-person team. One person feeds the turf into the seam, one person lines up the seam, and another makes adjustments with the carpet stretcher.

PRO TIP 6 | (Step 10) Make sure to place 3/4" lath screws every 6 inches around the perimeter.

PRO TIP 7 | (Step 11) Make sure to complete multiple passes with a drop spreader and then broom it in before continuing. Install the infill to the specifications of the turf you are installing.

PRO TIP 8 | (Step 12) Always broom the infill against the grain of the turf!

Golden Vale Synthetic Turf RESOURCES



YouTube Link



Website Link